

# Swivel castor CSS 125 EK

Transport Series CD - Wheel E



-20 °C - +70 °C

++  
swivels easily

++  
wear resistant

++  
shock proof

+++  
floor protective

++  
weather proof



## Wheel



Tread: Elastic solid rubber tyre, black, 73±5 Shore A, vulcanised on wheel centre

Wheel centre: Die-cast aluminium alloy

## Fork



Finish: electro-zinc plated, double ball bearing – revited, hardened steel balls thermoplastic dust protection ring, wheel axle bolted, total lock

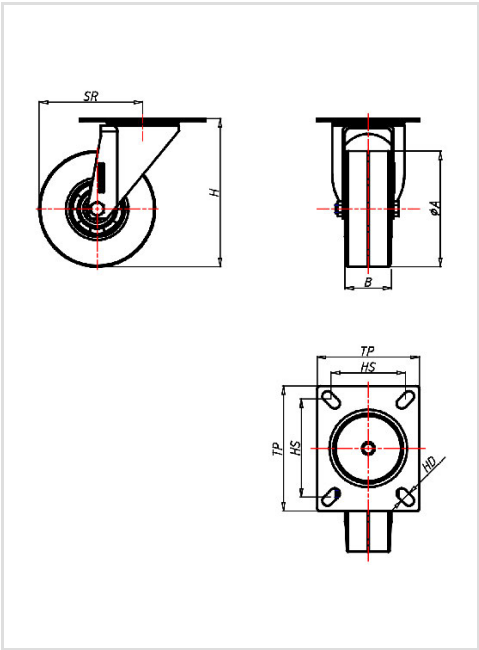

Swivel castor	Wheel-Ø A x width B mm: 125x50
Load Capacity kg:	200
Load capacity tested according to EN 12530 and EN 12527	
Overall height H mm:	160
Dimension of top plate TP mm:	135x110
Hole spacing HS mm:	105x80
Hole-Ø HD mm:	11
Swivel radius SR mm:	114
Wheel bearing:	Ball bearing

## Advantages

- ✓ excellent running performance
- ✓ very silent in motion
- ✓ low rolling resistance
- ✓ good abrasion resistance
- ✓ corrosion resistant
- ✓ non-marking in grey

## Applications

- Bins
- Refuse bins
- Dollies
- Trash containers
- Refuse containers